



CUSTOM CHROME

Instructions

Bullet Light Mounts

CCI #27-995

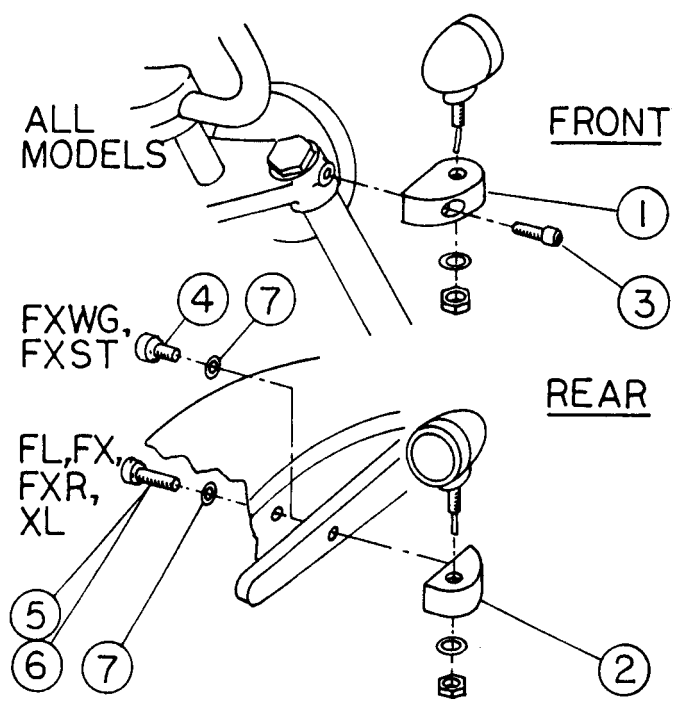

1. Use Loctite (CCI #35-007) on first three threads of bolts.
2. This kit contains hardware for usage on all applications listed below:

APPLICATION	FRONT HARDWARE	REAR HARDWARE
FL, FX, XL	5/16" - 24 x 5/8" (2 req.) (thru 1987)	3/8" - 16 x 1 1/4" (2 req.) 3/8 Lockwasher (2 req.)
FXR	5/16" - 24 x 5/8" (2 req.) (1982-87 35mm forks)	3/8" - 16 x 2 1/4" (2 req.) 3/8" Lockwasher (2 req.)
FXST, FXWG	5/16" - 24 x 5/8" (2 req.)	3/8" - 16 x 5/8" (2 req.) 3/8" Lockwasher (2 req.)

3. OEM aluminum fender struts must be modified by removing protrusions that stabilized original turn signal mounts.
4. FXR's using CCI #28-707 struts require 3/8" - 16 x 1 1/4" bolts.
5. FXST's and FXWG's require 3/8" - 16 x 5/8" bolts that insert behind strut only and not behind fender.
6. Some XL's and FXR's have 5/16" holes that must be enlarged to accept 3/8" bolts.