



## QUICK-DETACH PASSENGER ARMRESTS

### 8979

### PARTS INCLUDED

- 1 Left Side Mount Bracket - Black
- 1 Right Side Mount Bracket - Black
- 1 Left Armrest Bracket - Chrome
- 1 Right Armrest Bracket - Chrome
- 1 Left Armrest Tube Assembly
- 1 Right Armrest Tube Assembly
- 1 Left Side Armrest Pad
- 1 Right Side Armrest Pad
- 1 Hardware Kit
  - 2 5/16"-24 X 1-1/4" Button Socket Head Cap Screw
  - 2 M8 1.5" OD x .325 ID UHMW Flat Washer—**Large Diameter White**
  - 4 M8 Plastic Flat Washers—**Small Diameter White**
  - 4 M8 Steel Flat Washers
  - 6 5/16" Narrow Flat Washers
  - 2 5/16"-24 Hex Nylon Locking Nuts
  - 2 Black Rubber Plugs
  - 2 1/4"-20 x 5/8" Oval Head Screws
  - 6 1/4"-20 x 1/2" Post Screws
  - 6 1/4"-20 x 1/4" Post Screws
  - 1 Offset 1/2" Wrench
- 1 Intercom Cable Relocator Bracket Kit
  - 1 Intercom Cable Relocator Bracket
  - 3 #10-32 x 7/16" Button Socket Cap Screws
  - 3 #10-32 Nuts with Tooth Washer
- 1 Installation Instructions

Please read and understand entire instructions before starting installation.

### THANK YOU FOR CHOOSING KÜRYAKYN!

**IN ORDER TO PROTECT YOU AND OTHERS FROM POSSIBLE INJURY AND/OR PROPERTY DAMAGE OR LOSS, PLEASE PAY CLOSE ATTENTION TO ALL INSTRUCTIONS, WARNINGS, CAUTIONS AND NOTICES REGARDING THE USE AND CARE OF THIS PRODUCT.**

<b>WARNING</b>	<b>THIS INDICATION ALERTS YOU TO THE FACT THAT IGNORING THE CONTENTS DESCRIBED HEREIN CAN RESULT IN POTENTIAL DEATH OR SERIOUS INJURY.</b>
<b>NOTICE</b>	<b>This indication alerts you to the fact that ignoring the contents described herein may negatively affect product performance and functionality.</b>

<b>NOTICE</b>	<b>IF INSTALLING THIS PRODUCT FOR ANOTHER PARTY, PLEASE MAKE SURE THEY RECEIVE THIS COPY OF THE INSTALLATION INSTRUCTIONS SO THEY ARE AWARE OF THE IMPORTANT INFORMATION CONTAINED IN THEM.</b>
---------------	---

### TOOLS SUGGESTED

Set of Hex Wrenches, Socket Set with Ratchet, Set of Torx Wrenches, Screwdriver Set

**STRICTLY OBSERVE THE FOLLOWING GUIDELINES IN ORDER TO USE THE PRODUCT PROPERLY AND AVOID POTENTIALLY DANGEROUS ACCIDENTS.**

### CUSTOMER SERVICE

877.370.3604 (toll free)

### INSTALLATION QUESTIONS

techsupport@kuryakyn.com  
or call 715.247.2983

### LIMITED WARRANTY

Kuryakyn warrants that any Kuryakyn products sold hereunder, shall be free of defects in materials and workmanship for a period of one (1) year from the date of purchase by the consumer excepting the following provisions:

- Kuryakyn shall have no obligation in the event the customer is unable to provide a receipt showing the date the customer purchased the product(s).
  - The product must be properly installed, maintained and operated under normal conditions.
  - Kuryakyn makes no warranty, expressed or implied, with respect to any gold plated products.
  - Kuryakyn shall not be liable for any consequential and incidental damages, including labor and paint, resulting from failure of a Kuryakyn product, failure to deliver, delay in delivery, delivery in nonconforming condition, or for any breach of contract or duty between Kuryakyn and a customer.
- Kuryakyn products are often intended for use in specific applications. Kuryakyn makes no warranty if a Kuryakyn product is used in applications other than intended.
- Kuryakyn electrical products are warranted for one (1) year from the date of purchase by the consumer. L.E.D.'S contained in components of Kuryakyn products will be warranted for defects in materials and workmanship for 3 years from the date of purchase where as all other components shall be warranted for one(1) year. This includes, but is not limited to; control modules, wiring, chrome & other components.

• Kuryakyn makes no warranty of any kind in regard to other manufacturer's products distributed by Kuryakyn. Kuryakyn will pass on all warranties made by the manufacturer and where possible, will expedite the claim on behalf of the customer, but ultimately, responsibility for disposition of the warranty claim lies with the manufacturer.

### ABOUT OUR CATALOG

For purchasing Kuryakyn® products, you can receive a complete catalog free of charge. Send the Proof-of-Purchase below with your address to: Kuryakyn, P.O. Box 339, Somerset, WI 54025. Please indicate either Accessories Catalog for Harley-Davidson® or GL & Metric Cruisers.

Be sure to ask your local dealer about other Kuryakyn® products, the motorcycle parts and accessories designed for riders by riders.

©2005 Kuryakyn USA® All Rights reserved.



**STEP 1** Read and understand all steps in the instructions before starting the installation. Park the motorcycle on a hard, level surface and turn off the ignition.

**STEP 2** Open the Tour-Pak and remove the Tour-Pak liner.

**STEP 3** Under the Tour-Pak, locate the 3 fasteners on the right side shown in PIC 1. Remove the nuts.

**NOTE:** The rear nut on the right side is bolted, you will need to hold the bolt head inside the Tour-Pak to loosen.

**STEP 4** Locate the black right side mount bracket (See PIC 2). Hold the bracket in place under the Tour-Pak and line up the holes in the bracket with the holes in the bottom of the Tour-Pak.

**STEP 5** For '05 and earlier models you will need to use the 1/4-20x1/4 Post Screws, and for '06-up models you will use the 1/4-20x1/2 Post Screws. Apply the 5/16 narrow flat washers to the according post screws and attach these to the Tour-Pak. PIC 3

**STEP 6** Repeat Steps 3-5 for the left side.

**STEP 7** Determine the left arm hoop (sitting on the bike) from the right. When attached to the bracket and folded into the riding position, the mounting hole for the arm rest pad will point almost straight back PIC 4. Also, from the underside, the beveled edge of the casting stop will go towards the center of the bike. PIC 5

**STEP 8** Attach the right arm hoop to the right detachable bracket using a supplied 5/16"-24 X 1-1/4" Button Socket Cap Screw, steel M8 washer, M8 small diameter white washer, M8 large diameter white washer from the bottom side of the bracket PIC 6. Place a M8 large diameter white washer over the Button Socket Cap Screw threads from the top side of the bracket PIC 7. Place the arm hoop, then a M8 small diameter white washer, M8 steel washer and nylock nut as shown in PIC 8. Tighten snug. For an exploded view of this sequence, see Figure 1.

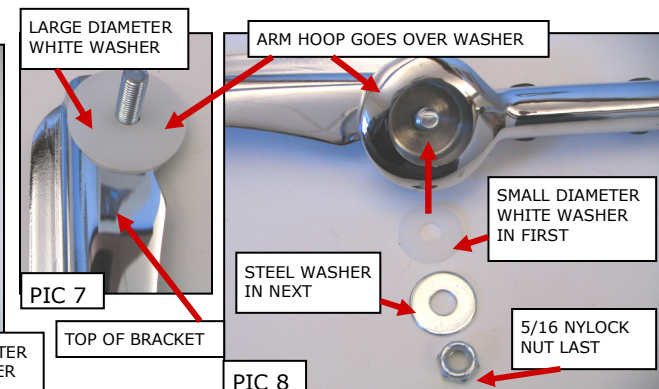
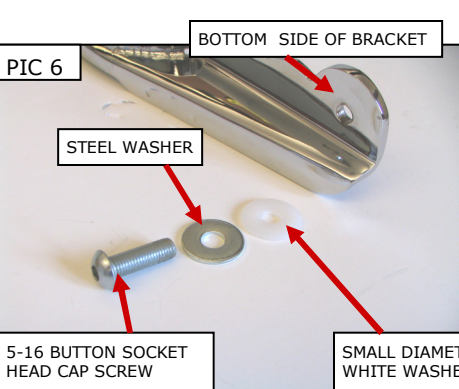
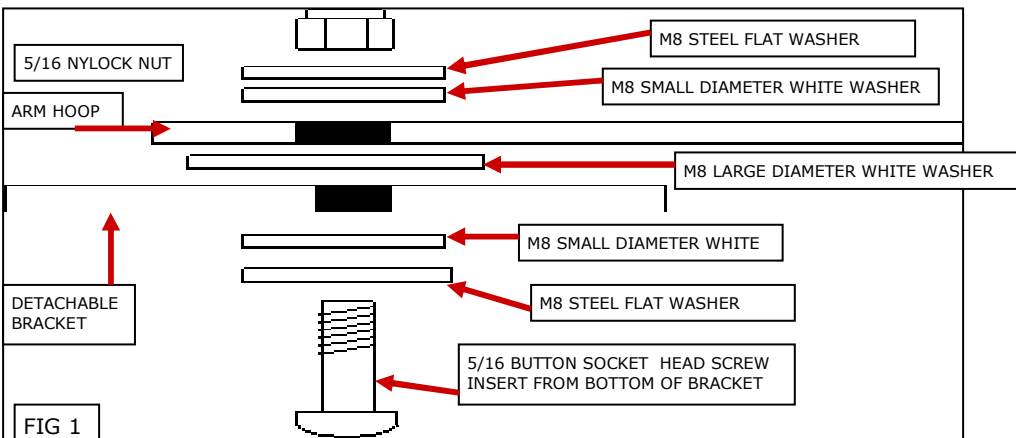
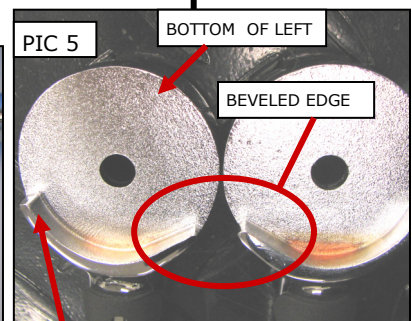
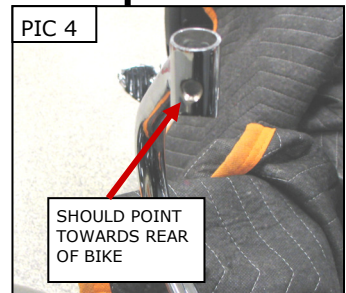
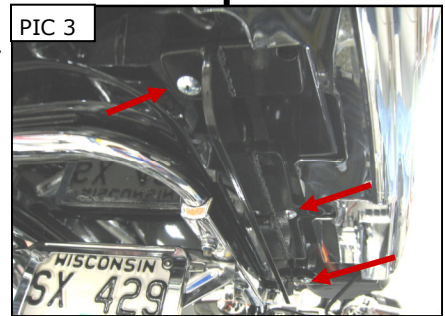
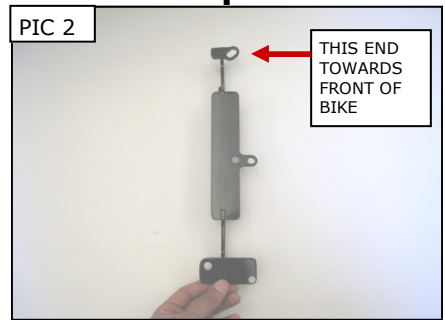
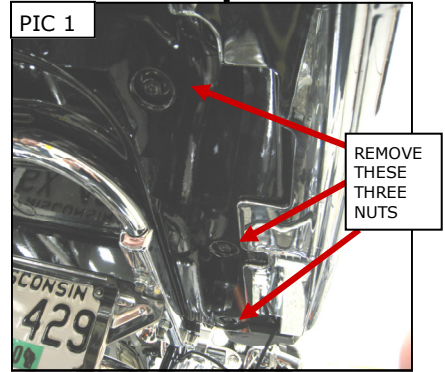

SQUARE EDGE TOWARDS OUTSIDE OF BIKE

-cont.-

**NOTE:** You can adjust the tension of the armrest movement by tightening or loosening the nylon locking nut. PIC 9

**STEP 9** For the right side, locate the armrest pad with drink holder attached. Slide in to place on the armrest tube and secure using a 1/4-20 x 5/8" Oval Head Screw.

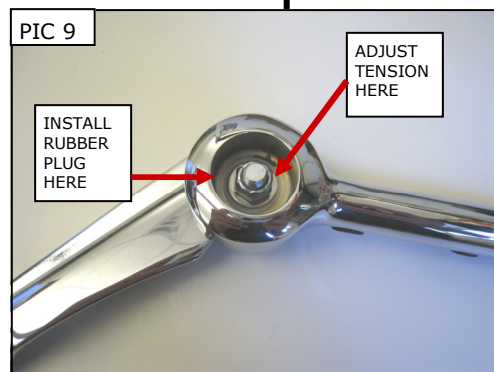

**STEP 10** As shown in PIC 10, hook the slotted end of the armrest bracket to the post on the mount bracket. Make sure that the post is seated completely in the slot.

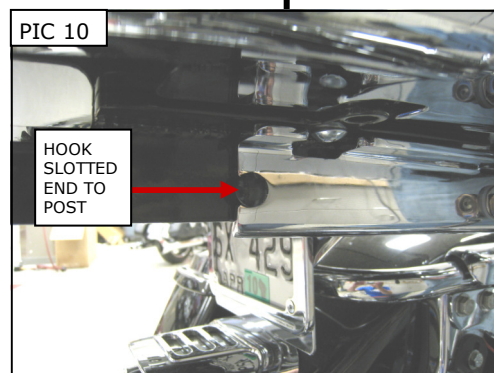

**STEP 11** Start threading the cam locks (PIC 11) in to the threaded holes in the black mounting bracket. Snug the cam locks and flip the levers to secure in place. Install the rubber plugs over the pivot bolt. PIC 9

**NOTE:** If you are having problems starting the cam locks, check that the indexing tab (located forward of the cam locks) is seated in the hole in the black mounting brackets.

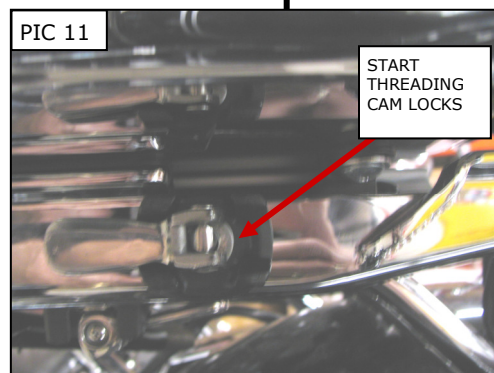

**WARNING** BEFORE EACH RIDE, CHECK TO SEE THAT THE CAM LOCKS ARE FOLDED OVER AND THAT THE ARMRESTS ARE SECURE.

**STEP 12** Repeat Steps 7-11 for the left side.

**WARNING** DO NOT OPERATE THE MOTORCYCLE WITH PASSENGER ARMRESTS FOLDED OUTWARDS.

**WARNING** PASSENGER ARMRESTS ARE NOT A SAFETY RESTRAINING DEVICE. FAILURE TO HOLD ONTO THE MOTORCYCLE MAY RESULT IN SERIOUS INJURY OR DEATH.

**WARNING** THIS PRODUCT WAS DESIGNED FOR USE AS A PASSENGER ARMREST ONLY. DO NOT USE AS AN ASSIST TO MOUNT OR DISMOUNT THE MOTORCYCLE, OR APPLY YOUR FULL BODY WEIGHT TO THE ARMRESTS TO ADJUST SEATING POSITION.

**NOTICE** It is the installer's responsibility to ensure that all of the fasteners (including pre-assembled) are tightened before operation of the motorcycle. Küryakyn will not provide warranty coverage on products or components lost due to improper installation or lack of maintenance. Periodic inspection and maintenance are required on all fasteners.

**INSTALL THE INTERCOM CORD RELOCATOR (IF EQUIPPED)**

- STEP 13** Remove the four torx screws securing the left speaker cover; set them aside.
- STEP 14** Carefully remove the speaker from its mount; let it sit on the passenger seat for now.
- STEP 15** Remove the intercom cord from the clamp and let it hang.
- STEP 16** Remove the stock screw and nut from the intercom cord clamp; set the clamp aside, it will be re-used.
- STEP 17** Position the new cord relocater as shown in PIC 12.
- STEP 18** Insert two #10-32 x 7/16" cap screws through the bottom side of the relocater into the speaker compartment and secure with 10-32 Nuts with Tooth Washer.
- STEP 19** Slide the stock intercom clamp into the relocater (plastic hook first) and secure with a #10-32 cap screws, 10-32 Nuts with Tooth Washer. Tighten the nut.
- STEP 20** Reinstall the intercom cord in the clamp.
- STEP 21** Reinstall the speaker, cover and torx screws.

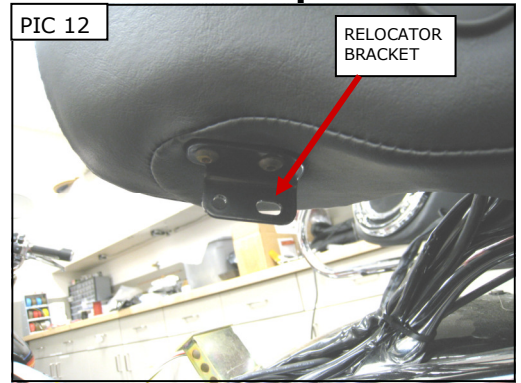

**NOTICE** Secure all wiring from the newly installed and/or from existing parts, away from any moving parts, pinch points or extreme heat. Küryakyn WILL NOT issue a warranty on any electrical component that fails due to pinched, crimped, broken, abraded, melted or frayed wires.

**NOTICE** It is the installer's responsibility to ensure that all of the fasteners (including pre-assembled) are tightened before operation of the motorcycle. Küryakyn will not provide warranty coverage on products or components lost due to improper installation or lack of maintenance. Periodic inspection and maintenance are required on all fasteners.