

after gasket contacts filter mounting surface. **Do not** use oil filter wrench for oil filter installation.

6. See [Figure 1-3](#). Install oil tank drain plug (2).
  - a. Inspect O-ring for tears or damage. Replace if necessary. Clean magnetic drain plug.
  - b. Install O-ring and drain plug. Tighten to 14-21 ft-lbs (19.0-28.5 Nm).
7. Refer to [Table 1-7](#). Initially add 2.0 quarts (1.90 liters) of engine oil. Use the proper grade of oil for the lowest temperature expected before the next oil change. Refer to [Table 1-2](#).

**Table 1-7. Engine Oil Capacity**

ITEM	CAPACITY
Engine oil (wet refill)	3.0 qt (2.84 L)
Engine oil (dry refill)	3.5 qt (3.31 L)

Use wet capacity values for engines that have just had the oil drained. Use dry capacity values for engines that have been disassembled, cleaned in solvent and dried.

8. See [Figure 1-1](#). Fully install oil filler plug/dipstick in oil tank.
9. Perform engine oil level hot check.
10. See [Figure 1-2](#). Add engine oil to bring oil level to the upper groove on the dipstick (FULL HOT).
11. Start engine and carefully check for oil leaks around drain plug and oil filter.

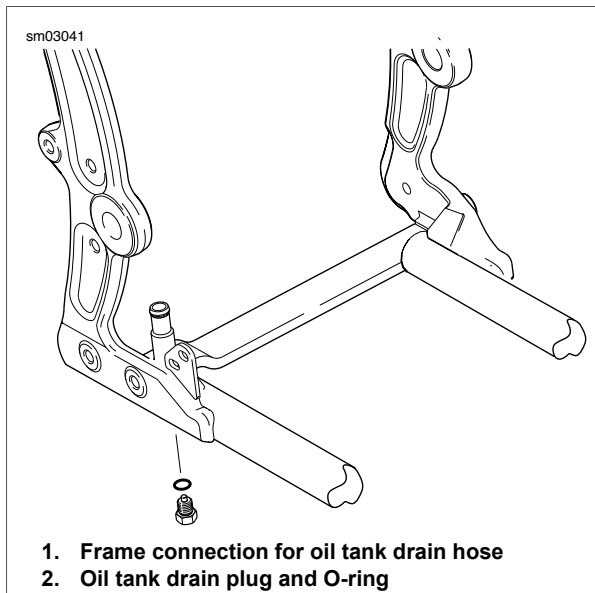

**Figure 1-3. Oil Tank Drain Plug**

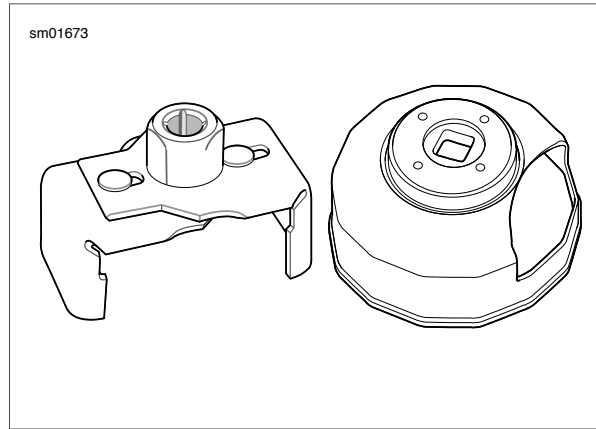

**Figure 1-4. Oil Filter Wrenches**

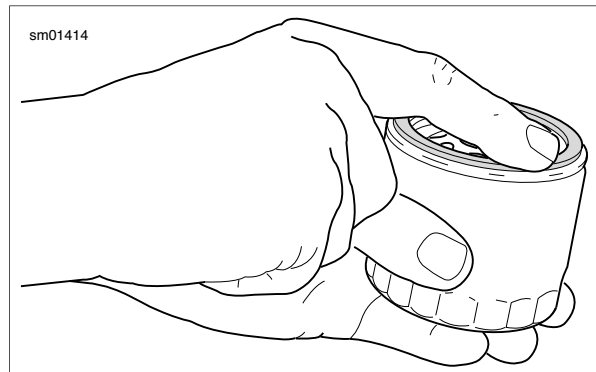

**Figure 1-5. Lubricating New Oil Filter Gasket**